

RunCam 5 Orange

User Manual

Instruction Diagram

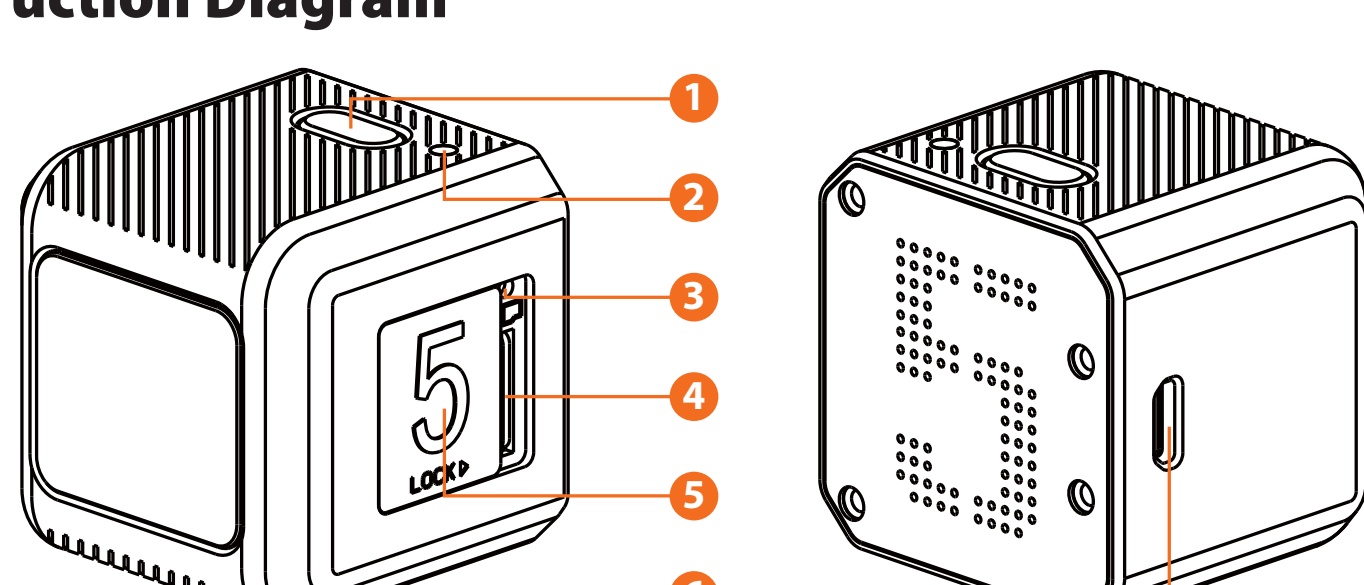

- 1 Shutter Button
- 2 Camera Status Light (LED)
- 3 Reset Button
- 4 SD Card Slot
- 5 SD Card Locking Door
- 6 Micro USB Port

Charging

Micro USB port supports DC 5-15V power supply. A DC 5V 1~2A charger is recommended. The **Red LED** will turn on during charging and turn off when charging is complete. It takes about 2 hours to get fully charged.

Low Battery Warnings

When powered on, if the charge is less than 25%, the **Blue LED** will continue to flash for 3 seconds.

Basic Camera Operation

Powering On/Off	• Long press the Shutter button with Green LED on, the camera is under standby mode.
Mode Switch	• Double-click the Shutter button to cycle through the recording mode (Green LED), setting mode (Blue LED)
Recording On/Off	• In the recording mode, click the Shutter button to start recording, the green light flashes; click the Shutter button again, the recording stops, the green light stops flashing.
Parameter Settings	• Set in the RunCam App
Forced Shutdown	• Simultaneously press the Shutter button and Reset button.
Formatting	• In standby mode. Triple-click the Reset button, with a long beep and Green LED blinks three times.
Reset	• In standby mode. Long press the Reset button, with three beeps and Blue LED blinks three times.

microSD Card

Insert the microSD card as indicated by the icon next to the card slot. Use brand name memory cards (sold separately) that meet these requirements:

- microSD, microSDHC, or microSDXC
- **U3 recommended** (2.7K50/2.7K60 1080P120 requires U3 or above; other resolutions require U1 or above)
- Capacity up to 128GB

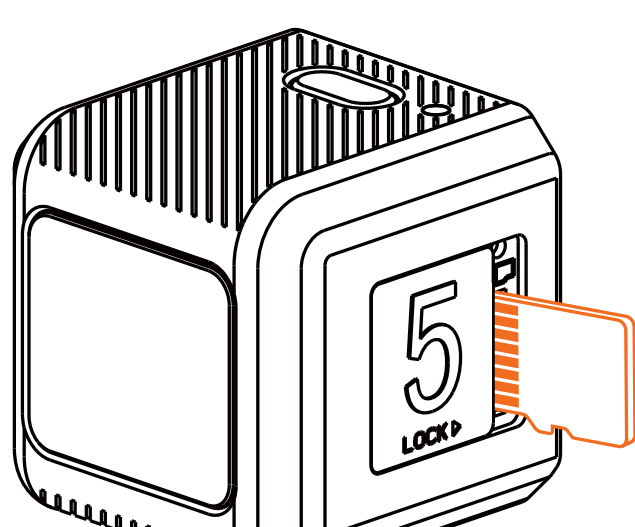

NOTICE: Use carefully when handling memory cards. Avoid liquids, dust, and debris. As a precaution, power off the camera before inserting or removing the card. Check manufacturer guidelines regarding use in acceptable temperature ranges.

Abnormal SD Card Status: If the blue light continues to flash quickly after powering on, it indicates that the SD card is not inserted, or full or cannot be recognized.

Connection to Computer

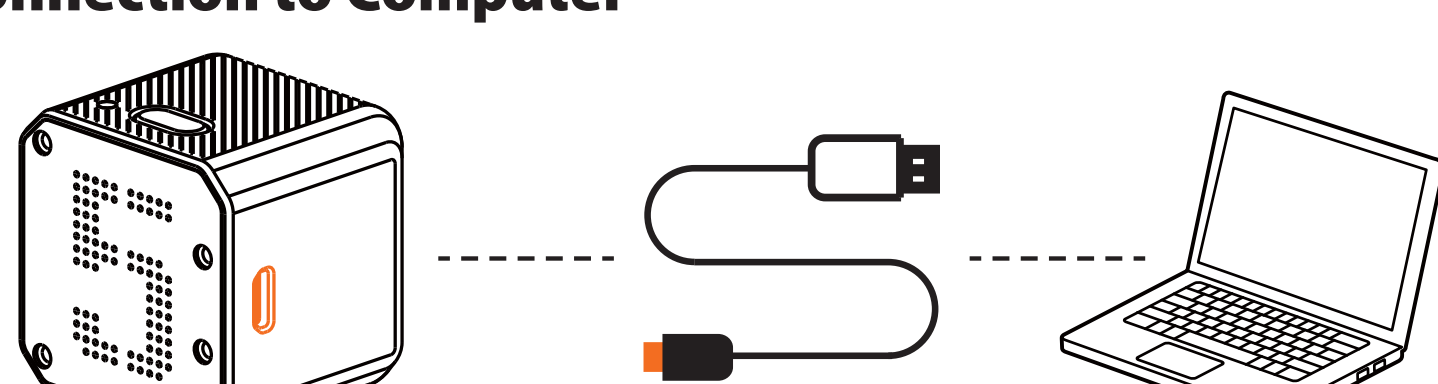

After turning on the camera, connect it to the computer via USB cable, then it will be recognized as a removable disc.

NOTICE: If the camera can not be recognized by the computer after connecting, please make sure that a microSD card is well inserted. If the information on microSD card can not be read normally, please try with another micro USB cable or USB port on the computer.

Firmware Upgrade

To ensure that the camera performs optimally, please use the latest firmware.

Update method here: <https://runcam.com/download/runcam5or>.

Video Bitrate and Codec

Resolution	Video Quality			Codec
	High	Medium	Low	
4K@30fps	60Mbps	50Mbps	40Mbps	H.264
2.7K@60fps	60Mbps	50Mbps	40Mbps	
2.7K@50fps	60Mbps	50Mbps	40Mbps	
1440P@60fps	40Mbps	30Mbps	20Mbps	
1080P@120fps	60Mbps	50Mbps	40Mbps	
1080P@60fps	45Mbps	30Mbps	22Mbps	

Parameter

Image Sensor	SONY IMX 377 (12MP)
Video Resolution	4K@30fps/2.7K@60fps/2.7K@50fps/1080P@120fps/1080P@60fps/1440P@60fps
Field of View (FOV)	145°
Video File Format	MP4
TV-OUT	Support
Communication Interface	Micro USB
microSD Card supported	Up to 128G. Samsung's U3 card is recommended (2.7K50/2.7K60 1080P120 requires U3 or above; other solutions require U1 or above) Please make sure that the file format of the SD card is FAT32, otherwise, it will easily cause errors.
WiFi	Nonsupport
Shutter	Auto 1/30 1/60 1/120 1/240
ISO	Auto/100/200/400/800/1600/3200
USB Power Input	DC 5-15V
Battery Capacity	900mAh
Power Consumption	Max 620mA @5V
Dimension	38*38*36mm
Net Weight	56g (with battery)

Technical Support

Please visit: <https://support.runcam.com>