

- 5 Kinds of DC motors are available: brushed 6V/12V/24V, brushless 12V/24V
- Flow rate range: DC brush 1~85ml/min, DC brushless 1.2~122ml/min
- Working conditions: temperature 0~40°C, humidity <80%
- Pump tube selection: silicone tube, PharMed®BPT tube, imported MasterFlex fluorine rubber tube
- Transmission mode: gear transmission, one slowdown 1:14, two slowdown 1:196.



The first-stage deceleration output speed is fast, focusing on large flow; the second-stage deceleration output speed is slow, focusing on micro-flow

- Pump head: The upper cover is made of high permeability PC plastic, and the pump body and gear are made of imported synthetic engineering plastics.
- Rotor: 3 Rotors, 6 Rotors

Technical Parameters

Pump tube length: 135mm (exposed 30mm) BPT tube (B) Viton (V)
175mm (exposed 50mm) Silicone tube (S)

Application Areas



Ion chromatograph



Automatic car washing machine



Blood analyzer



Hypochlorous acid water generator

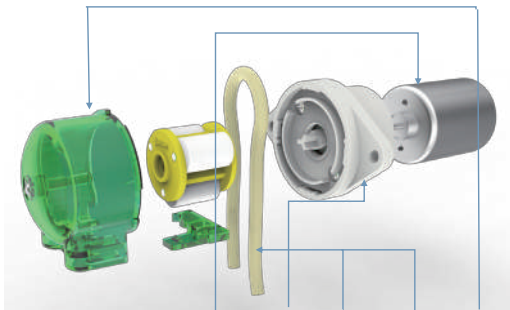

A schematic view of the pump head assembly
Unit: mm

The direction of the pump tube (can be adjusted by yourself)

Mounting plate hole size

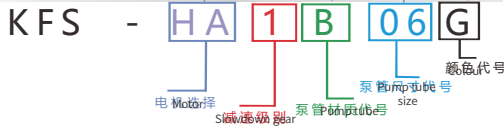
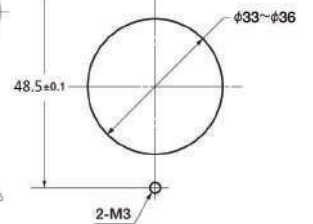
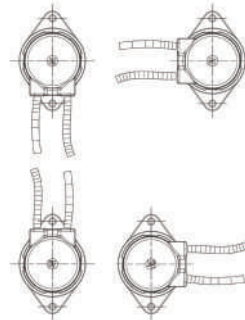
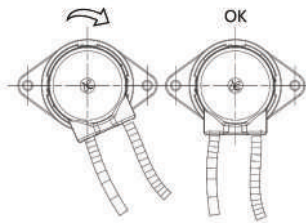

Dimensions

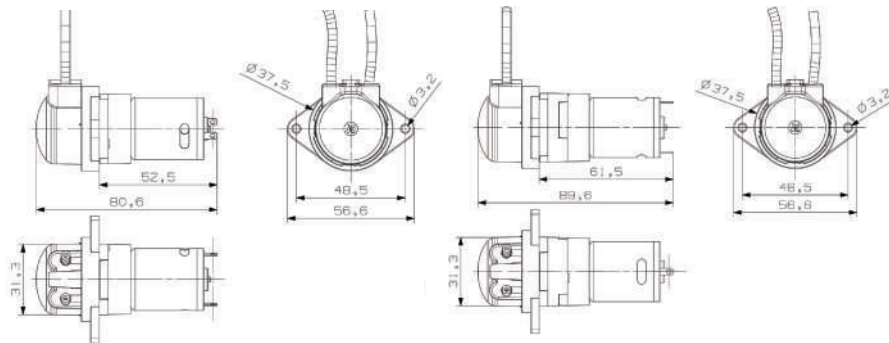

One slowdown gear Dimensions

Two slowdown gear Dimensions

Dimensions (brushed motor with sheet metal bracket) First deceleration

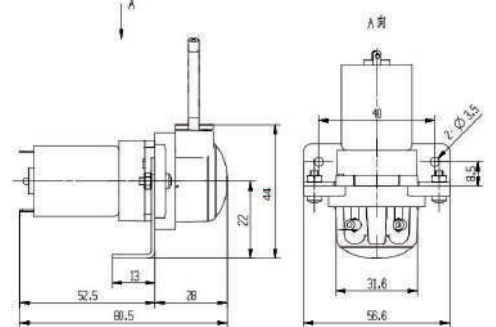



Two slowdown gear

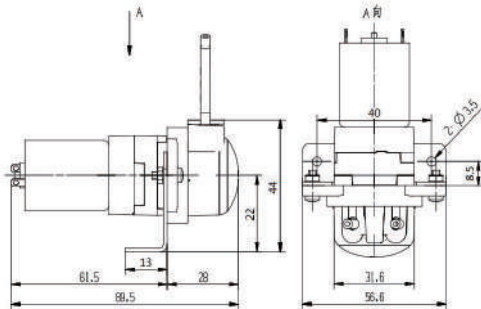

Dimensions (brushless DC motor)

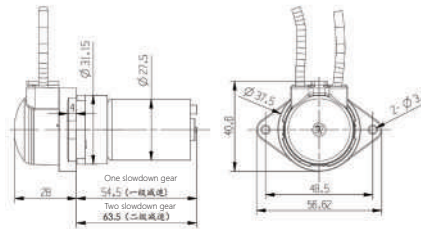

Brushless motor wiring diagram

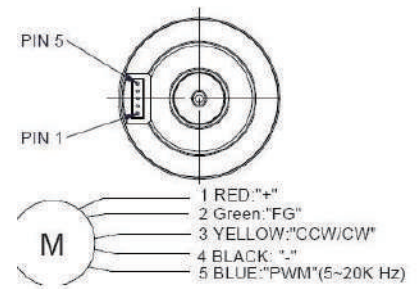

KFS Brushed Flow model selection

Code		S04	S06	S10	B04	B06	B10	V01	
OD*ID(mm)		1.0*3.3	2.0*4.0	3.0*5.0	1.0*3.3	2.0*4.0	3.0*5.0	2.54*4.24	
Materials		Silicon	Silicon	Silicon	BPT	BPT	BPT	Viton	
Flow rate(ml/min)	24V 0.2A (HA)	One slowdown gear	12ml/min	45ml/min	85ml/min	12ml/min	45ml/min	85ml/min	50ml/min
		Two slowdown gear	1ml/min	4ml/min	7ml/min	1ml/min	4ml/min	7ml/min	5ml/min
	12V 0.4A (HB)	One slowdown gear	12ml/min	45ml/min	85ml/min	12ml/min	45ml/min	85ml/min	50ml/min
		Two slowdown gear	1ml/min	4ml/min	7ml/min	1ml/min	4ml/min	7ml/min	5ml/min
	6V 0.6A (HC)	One slowdown gear	12ml/min	45ml/min	85ml/min	12ml/min	45ml/min	85ml/min	50ml/min
		Two slowdown gear	1ml/min	4ml/min	7ml/min	1ml/min	4ml/min	7ml/min	5ml/min
Ideal working conditions: Environmental temperature 0~40°C Relative humidity <80%									

Note: when the environmental noise is 35dB, the measured noise is 50dB at a distance of 50cm, and it is measured at 63dB for the attached product.

KFS Brushless Flow model selection

Code		S04	S06	S10	B04	B06	B10	V01	
ID*OD(mm)		1*3	2*4	3*5	1*3	2*4	3*5	2.54*4.24	
Materials		Silicon	Silicon	Silicon	BPT	BPT	BPT	Viton	
Flow rate(ml/min)	24V 0.2A (HD)	One slowdown gear	12	65	116	18	56	122	70
		Two slowdown gear	1.2	4.5	8.3	1.3	4.3	8.5	6
	12V 0.35A (HE)	One slowdown gear	12	65	116	18	56	122	70
		Two slowdown gear	1.2	4.5	8.3	1.3	4.3	8.5	6
Tubing size: 135mm(30mm exposed)BPT tubing(B)fluorine tubing 175mm(50mm exposed)silicone tubing(S)(V) Ideal working conditions: Environmental temperature 0~40°C Relative humidity <80% When the environmental noise is 48db, the full load of 60dB measured at 30cm reduces the speed of the pump head and sacrifice flow rates, the noise can be reduced.									