

I. Specification (unit: mm)

Item: SEN-SZ21WA
1. Output cable way: insert
2. Shell material : Nylon
3. Installation : Any

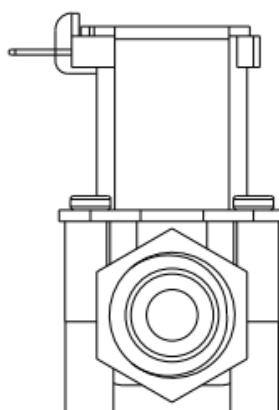
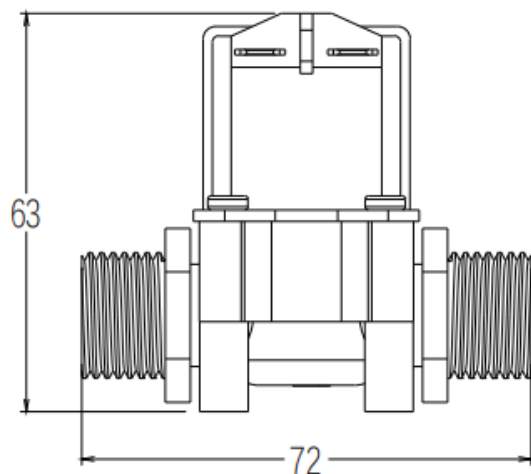
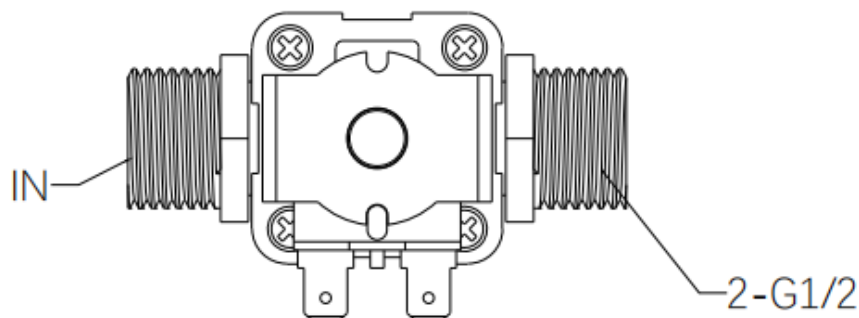

II. Introduction

The valve is installed in the water pipe to control the flow and close of water.

When the solenoid valve is powered on, Water solenoid valve open, water flow, when disconnected power, water off, it's mainly used for liquid water opening & closing control

III. Technical parameters

Range of application		Applicable fluid control:
Base parameter	1. Working voltage	AC220V / DC12V / DC24V
	2. Working current	0.048(220V) / 0.48(12V) / 0.235A(24V)
	3. Power	9.97(220V) / 5.76(12V) / 5.64W(24V)
	4. Working pressure range	0.02~0.8Mpa (Instantaneous max pressure 1.75Mpa)
	5. Using temperature range	0~80°C (low temperature)
	6. Coil resistance	4.85KΩ (220V) / 25Ω (12V) / 100Ω (24V)
	7. Starting characteristic	At 0.8Mpa, 0.9 times the rated voltage is applied to both ends of the solenoid valve coil, and the solenoid valve should be opened and maintained
	8. Storage Temp	-20~+80°C (Ice-free state)
	9. Storage Relative Humidity	25%~95%RH
Technical parameter	1. Voltage and characteristic	When the power supply voltage is 0.9 times to 1.1 times the rated voltage, the solenoid valve should be able to open and close normally within the operating water pressure range of the solenoid valve.
	2. Sealing property	The electromagnetic valve lasts for 30s under the action of the water inlet water pressure of 0.02MPa, and the leakage is required to be less than 0.1ml; At pressure of 0.02MPa~0.8MPa, there is no leakage phenomenon
	3. Working life	When the hydrostatic pressure is 0.8MPa, under the action of 1.1 times the rated voltage, the solenoid valve is opened for 3s and closed for 3s for 7×24h (about 100,000 times) without abnormality
	4. Insulation resistance	The insulation resistance between the conductive part and the exposed non-charged metal part should be ≥20MΩ
	5. Pulling strength	Apply a pulling force of 10N on the lead-out wire for 1 minute, without loosening or breaking

IV. Instructions

- The type of solenoid valve: pressure normally closed solenoid valve;
- Installation mode: take the arrow of the product as the direction of water entry, install in any direction;
- Please read the instructions carefully before using valve, if you have questions, please consult our engineer.
- The valve with this structure has never been used, and it may be inappropriate to directly replace it.
- In order to prevent particles and debris from entering the solenoid valve, a filter must be installed at the water inlet.
- Magnetic materials change their characteristics when they are brought close to the valve.
- Install and use to avoid places with strong vibration and shaking, so as to avoid wrong indication
- Do not disassemble valve. it is not covered by the warranty.

9. Service tel: 0757-22905969

E-mail: sales4@chnsensor.com

<http://www.saiersensor.com>